

**Paw Prints**  
**5K RUN/WALK**

**Friends**  
of the  
Burlington County  
Animal Shelter

**Paw Prints 5k**  
**Eastampton Township, NJ**

**Notes:** Course has been measured in accordance with USATF/RRTC requirements using the shortest possible route method within 12" of all curbs and defined road and path edges.

Course is primarily the red blazed trail through The Historic Smithville park. A small portion is on the orange trail, but runners do not have to turn to get on this trail so it is not indicated on the map.

Measured by  
**Joe Berta**  
Philadelphia, PA  
07/18/2017

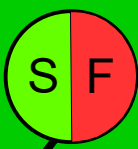

S/F – Even with west edge of sewer grate on north side of path. Exactly half way between the end of the north railing and light pole. Also 30 ft east of gazebo.

Mile 3 – 15 feet from south end of bridge, 2 fence lengths from the south, and on the middle of the 11<sup>th</sup> wooden plank from the south.

Mile 2 – 6 feet north of orange trailhead sign. 15 feet south from the southern edge of pavilion

Mile 1 – 6 feet east of red blaze tree at 5 point intersection. Minor trails not shown on map. Approximately 150 ft from playground.

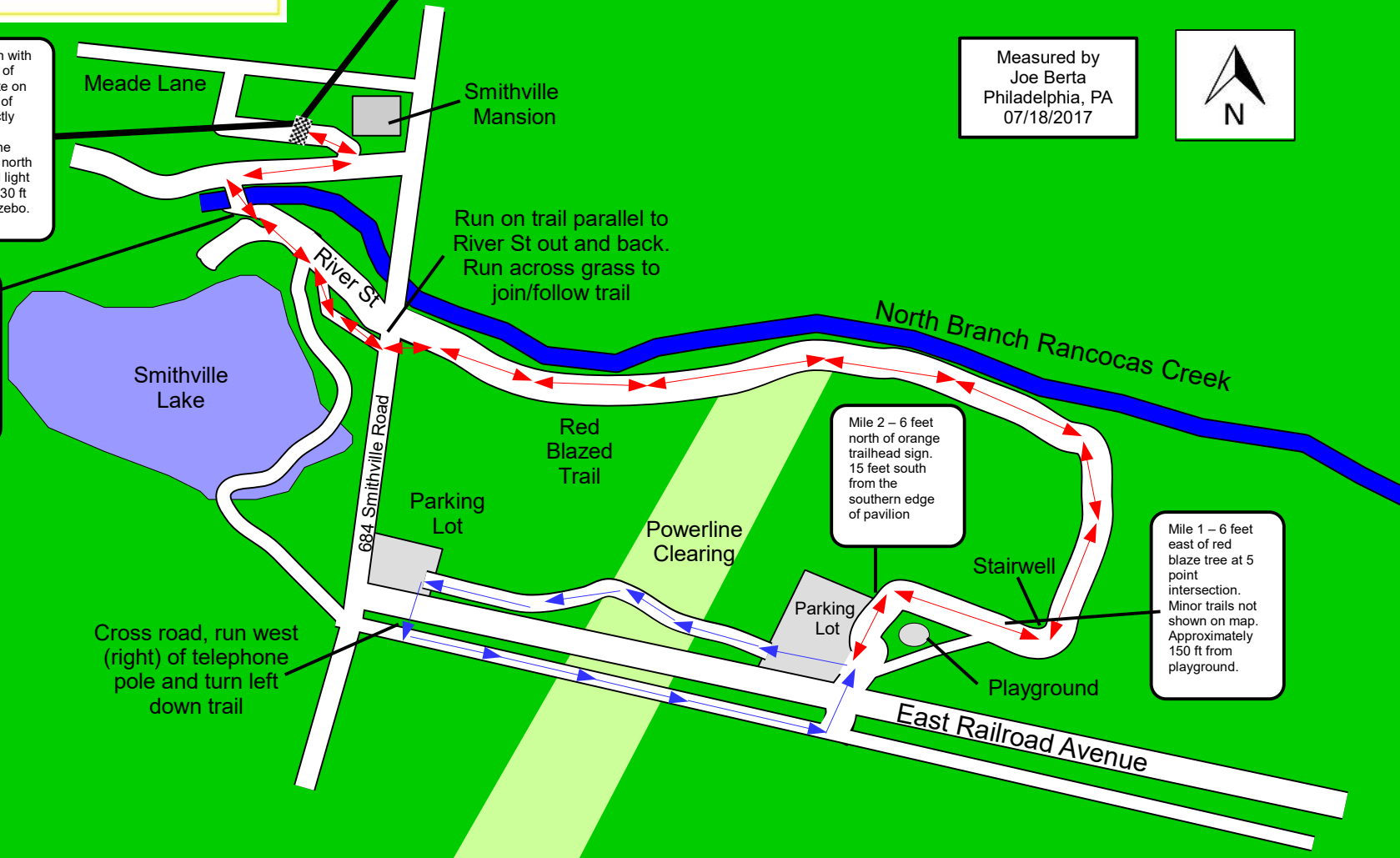

Meade Lane

Smithville Mansion

Run on trail parallel to River St out and back.  
Run across grass to join/follow trail

Smithville Lake

Parking Lot

Red Blazed Trail

Powerline Clearing

Parking Lot

Stairwell

Playground

East Railroad Avenue

Cross road, run west (right) of telephone pole and turn left down trail

684 Smithville Road

River St

North Branch Rancocas Creek